

REVISIONS			
REV.	DESCRIPTION	DATE	APPROVED
A	INITIAL	06/05/2016	

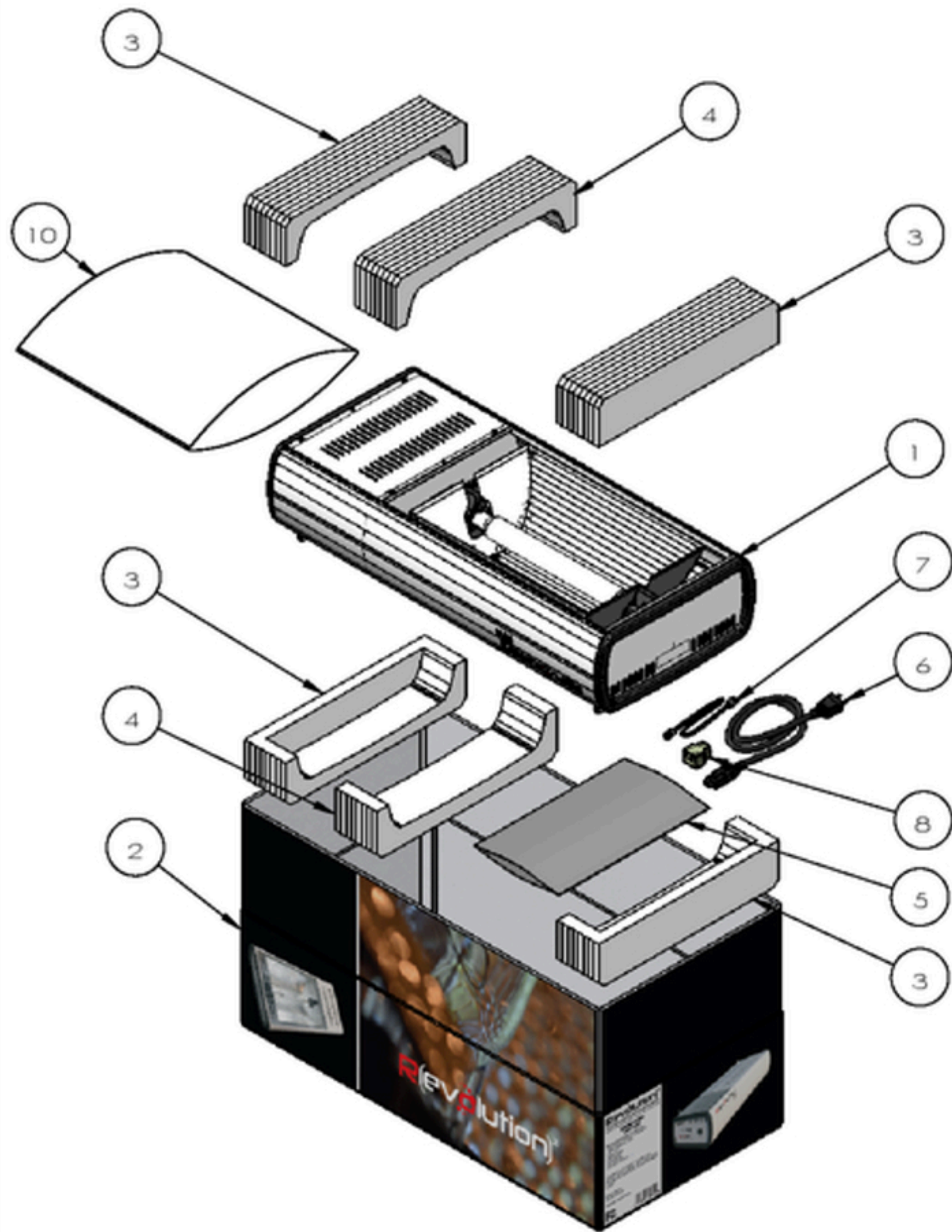

Box size : 36 Cm x 70 Cm x 20 Cm
Whight : 8.5 Kg

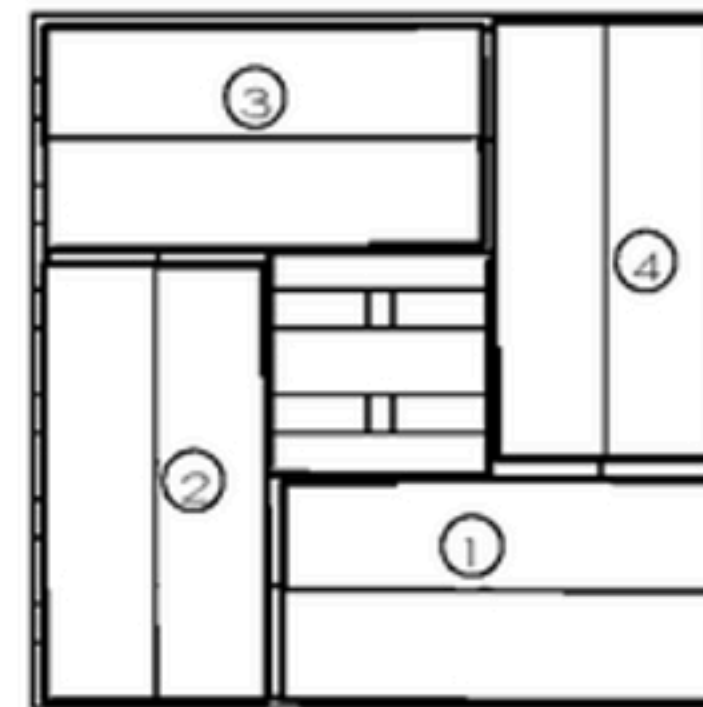

4 CTN / layer

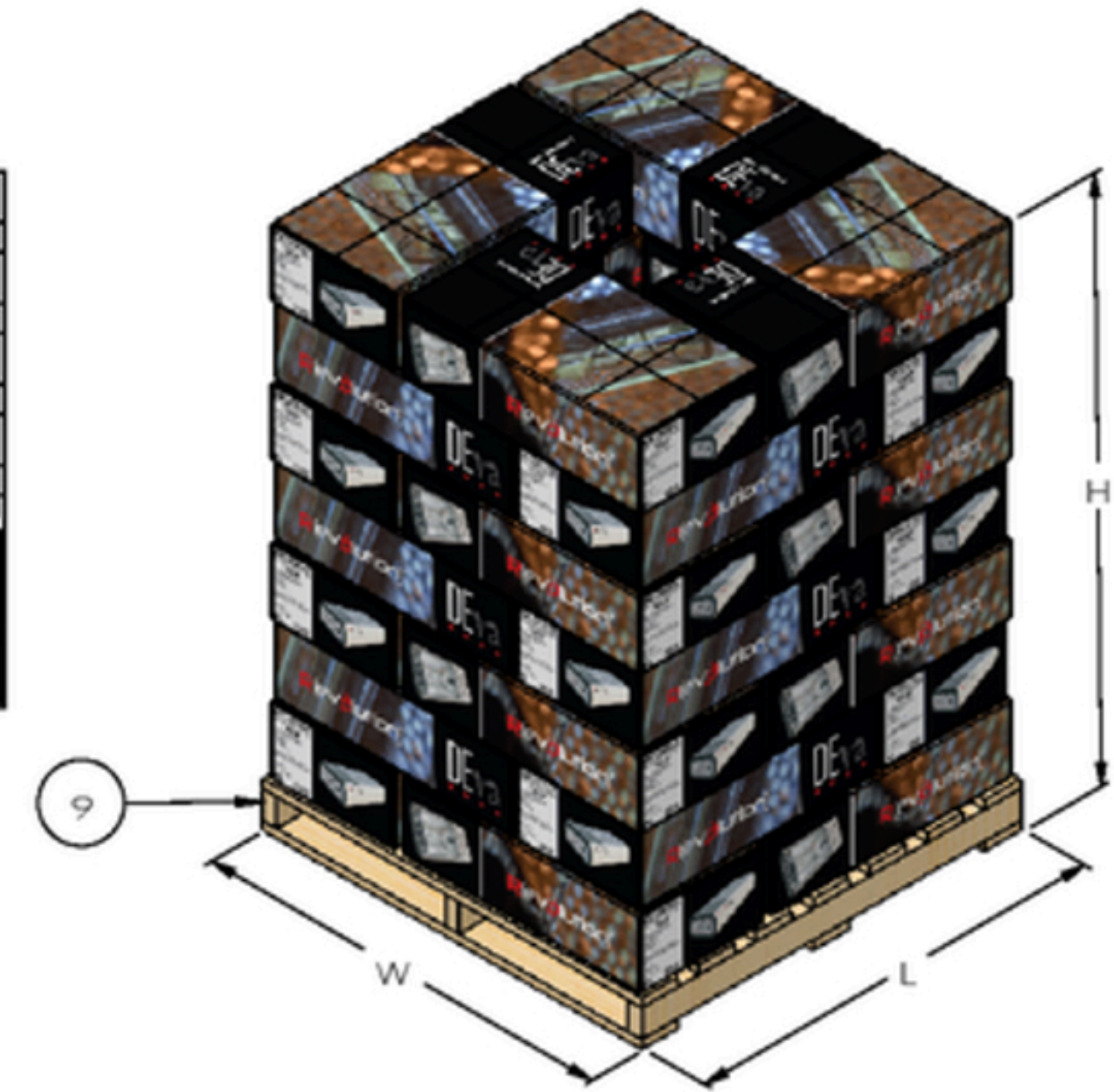

4 x 7 = 28 Pcs by Air (W110 Cm. x L110 Cm. x H155 Cm. Weight = 253 Kg)
4 x 9 = 36 Pcs by Sea (W110 Cm. x L110 Cm. x H195 Cm. Weight = 321 Kg)

ITEM NO.	PART NUMBER	DESCRIPTION	QTY.
1	R-DW-AS-026	Ass'y Drawing for DEva 1000W	1
2	R-DW-PK-039	Paper Box 4 color Ballast Deva	1
3	R-DW-PK-040-1	EPE foam front/backBallast Deva	4
4	R-DW-PK-040-2	EPE foam mid Ballast Deva	2
5	R-DW-PK-033	EPE Foam bag W160 x L290 x T 1.0mm White color	1
6	R-XH006A-MG	AC Power Cord 3x14AWG x 6 FT with Magnetic core	1
7	R-DW-HN-019-1	Telephone Cable RJ11 6P4C L = 3M. Black	1
8	R-RJ12-6P6C-Y	RJ12 6P6C Y Spriter	1
9	-	Wooden Pallet 110x110	1/28
10	R-DW-PK-047	Plastic Bag W 50cm x 100 cm	1

CUSTOMER signature and date	THIRD ANGLE PROJECTION	DESIGN signature and date	DRAWN signature and date	CHK'D signature and date	APPV'D signature and date	DIMENSIONS ARE IN MILIMETERS		Revolution Microelectronics Co.Ltd	
						DWG NO. R-DW-PK-046	DWG Date 06/05/2016	Packing Standard for Deva 1000W	
						MATERIAL: -	Not to scale		REVISION A